

1

SPECTRA B300FLF

Flashing Beacon
 E14 Filament bulb
 Three selectable frequencies on PCB
 IP Rating: IP65
 Temp: -25°C to +50°C
 Unit weight: 283g
 CE

Dimensions : Ø100 x 150mm
 1.5mm² terminals
 Cable entry: 1 x 5-7mm push through
 grommet
 1 x M20 cable entry (IP65)

X = Lens colour
 R = Red
 B = Blue
 G = Green
 A = Amber
 C = Clear
 Y = Yellow

Order code	Voltage	Bulb Type E14	Version
B300FLF012B/x	12V DC 1.75A	E2S Part No.	12V 25W
B300FLF024B/x	24V DC 1.1A	BB261225E	24V 25W
B300FLF048B/x	48V DC 0.8A	BB263025E	48V 25W
B300FLF115B/x	115V AC 255mA	BB264825E	115V 25W
B300FLF230B/x	230V AC 130mA	BB2613025E	230V 25W
B300FLF3025E		BB2623525E	

Tel : +44 (0)20 8743 8880 Fax : +44 (0)20 8740 4200
 email : sales@e2s.com web : www.e2s.com



3

B300FLF

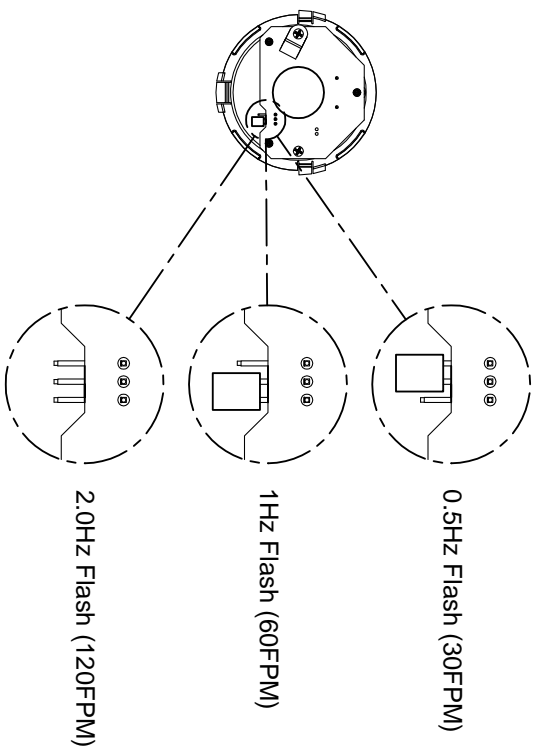

2

ATTENTION: Installation must be carried out by an electrician in compliance with the latest codes and regulations.

ATTENTION: Disconnect from power source before installation or service to prevent electric shock.

ATTENTION: Lens on unit will be hot allow to cool prior to removal.



A SPECIKRA B300FLF

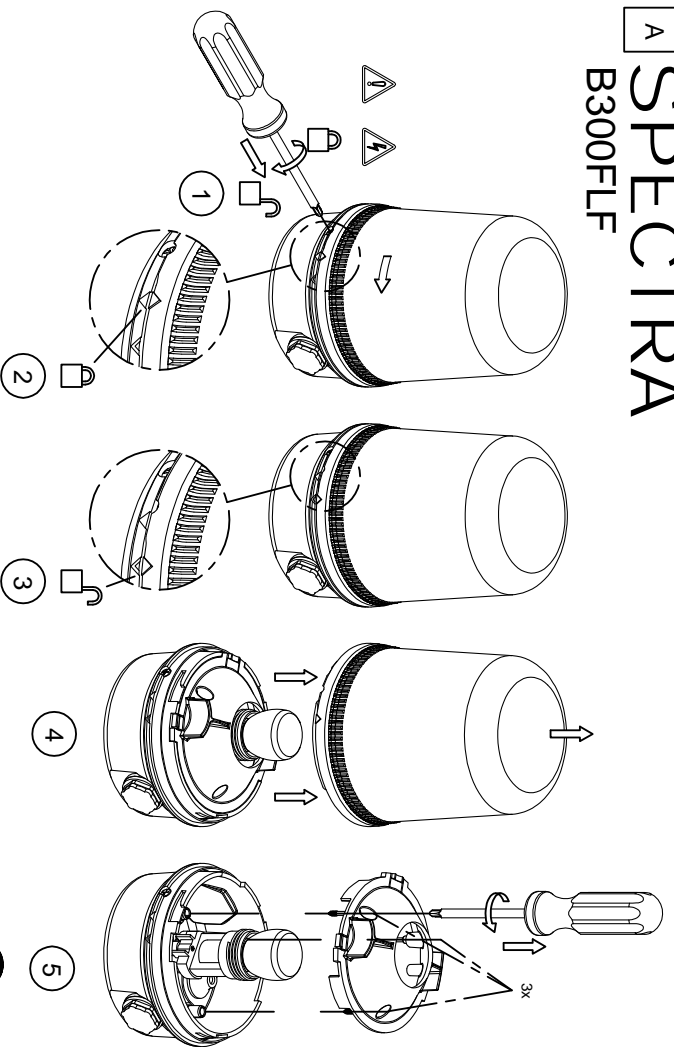

Tel : +44 (0)20 8743 8880 Fax : +44 (0)20 8740 4200
 email : sales@e2s.com web : www.e2s.com



MOUNTING OPTIONS	
a	STANDARD BASE
b	POLE MOUNT
c	90° BRACKET

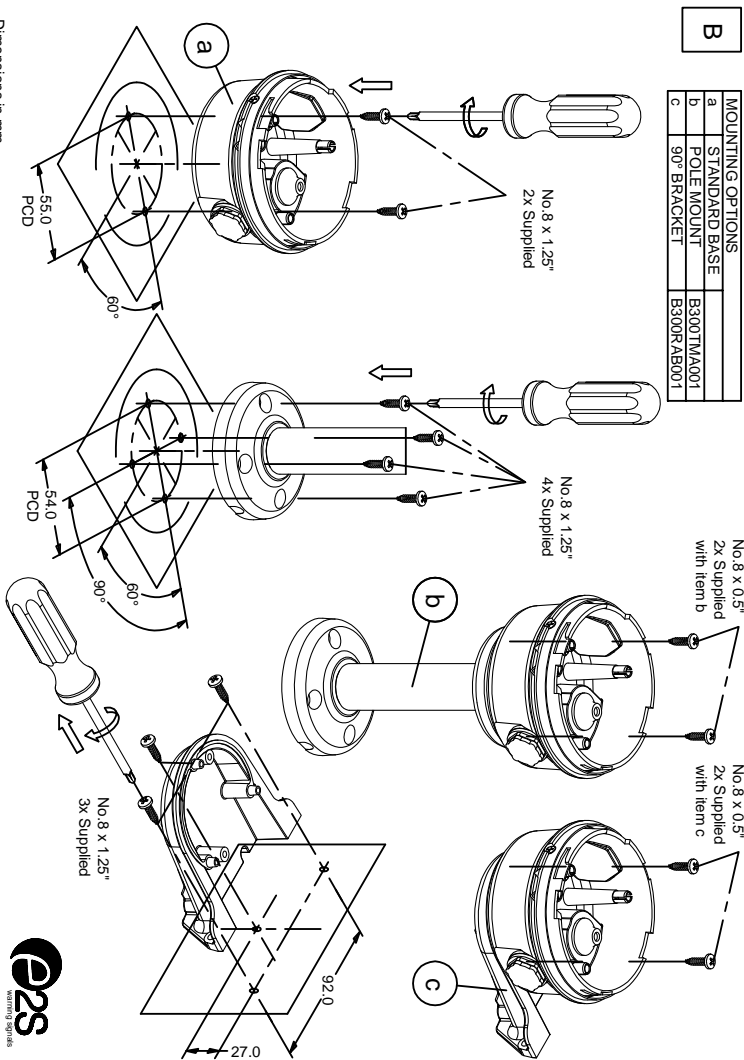

C

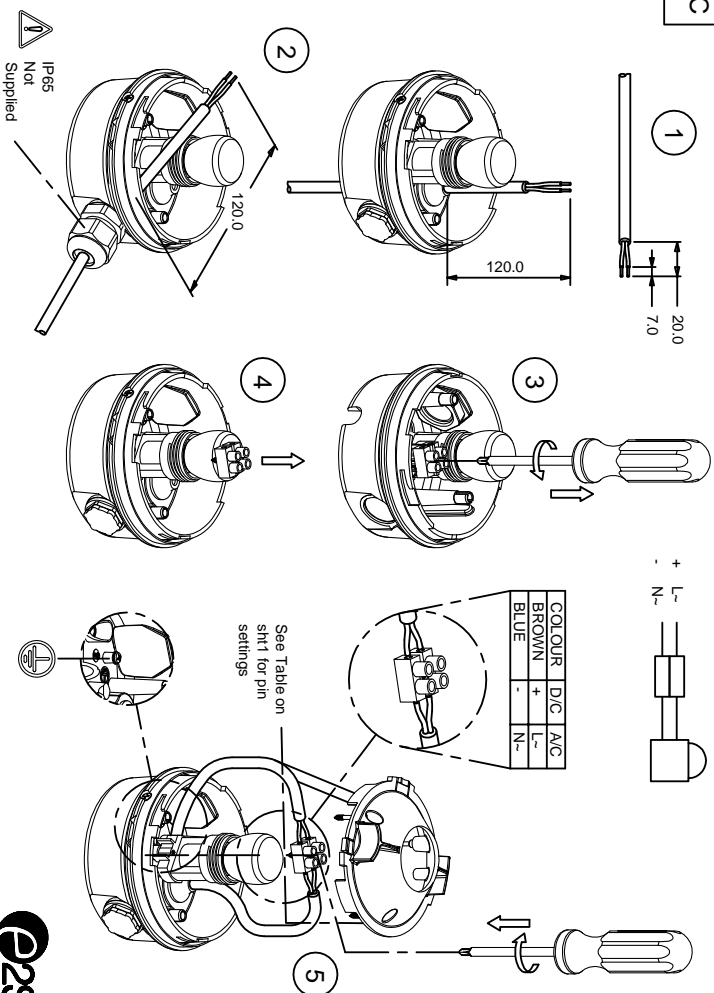

D

