

1

# SPECTRA B450TLA

Traffic Light L.E.D. Array Beacon  
 24 x High powered L.E.D's  
 IP Rating: IP65  
 Temp: -25°C to +50°C  
 Unit weight: 410g  
 CE

Dimensions : Ø140 x 177mm  
 2.5mm<sup>2</sup> terminals  
 Cable entry: 1 x 5-7mm push through  
 grommet  
 2 x M20 cable entry ( IP65)

Order code            Voltage  
 B450TLA030B/x 10-30V DC 175mA  
 B450TLA230B/x 90-230V AC 15-40mA

x = L.E.D. colour  
 R = Red                A = Amber  
 G = Green             C = Clear (White)

Multi-unit connection possible using  
 connector supplied  
 B450 and B350 units are interconnectable

B450TLA units are supplied with clear  
 lenses to optimise effectiveness in strong  
 ambient light

Tel : +44 (0)20 8743 8880 Fax : +44 (0)20 8740 4200  
 mail : sales@e2s.com web : www.e2s.com



2



**ATTENTION:** Installation must be carried out by an electrician in compliance with the latest codes and regulations.



**ATTENTION:** Disconnect from power source before installation or service to prevent electric shock.



**ATTENTION:** Lens on unit will be hot allow to cool prior to removal.



# A SPECTRA B450TLA

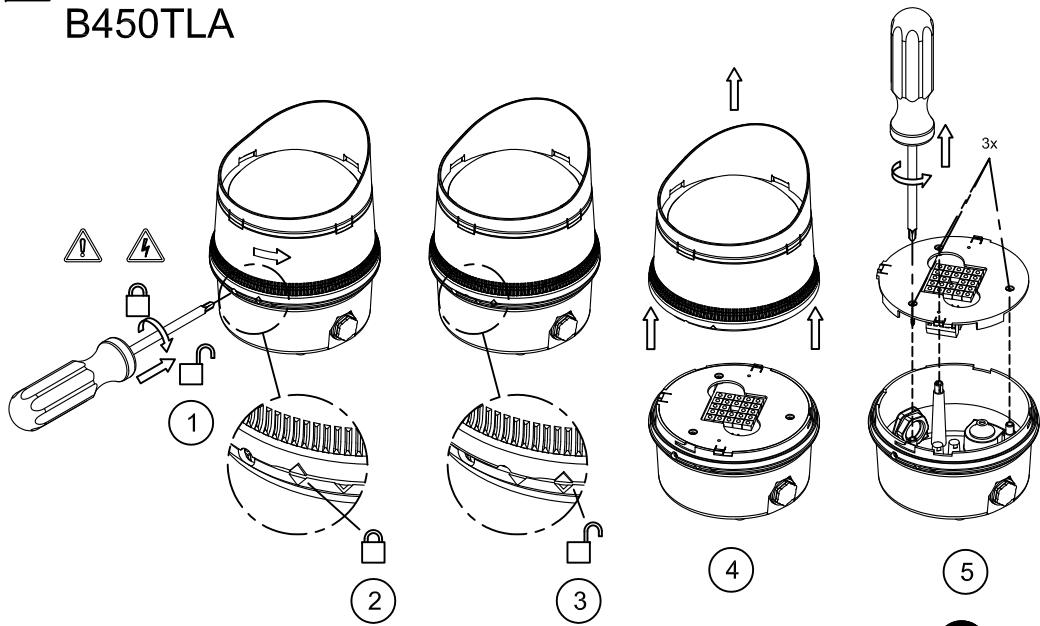

Tel : +44 (0)20 8743 8880 Fax : +44 (0)2 8740 4200  
mail : sales@e2s.com web : www.e2s.com



# C

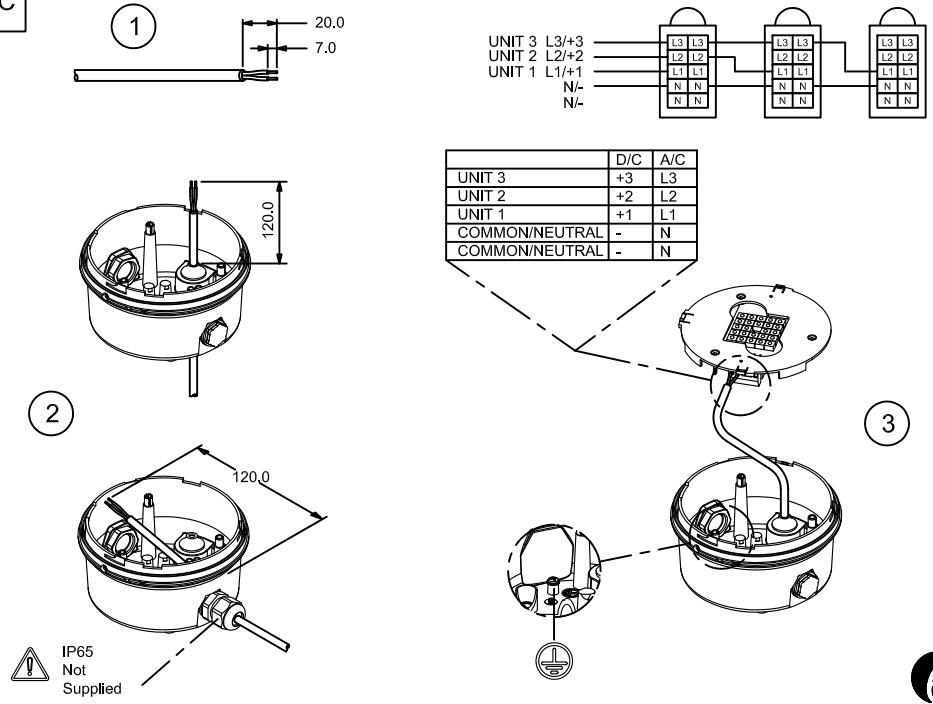

# B

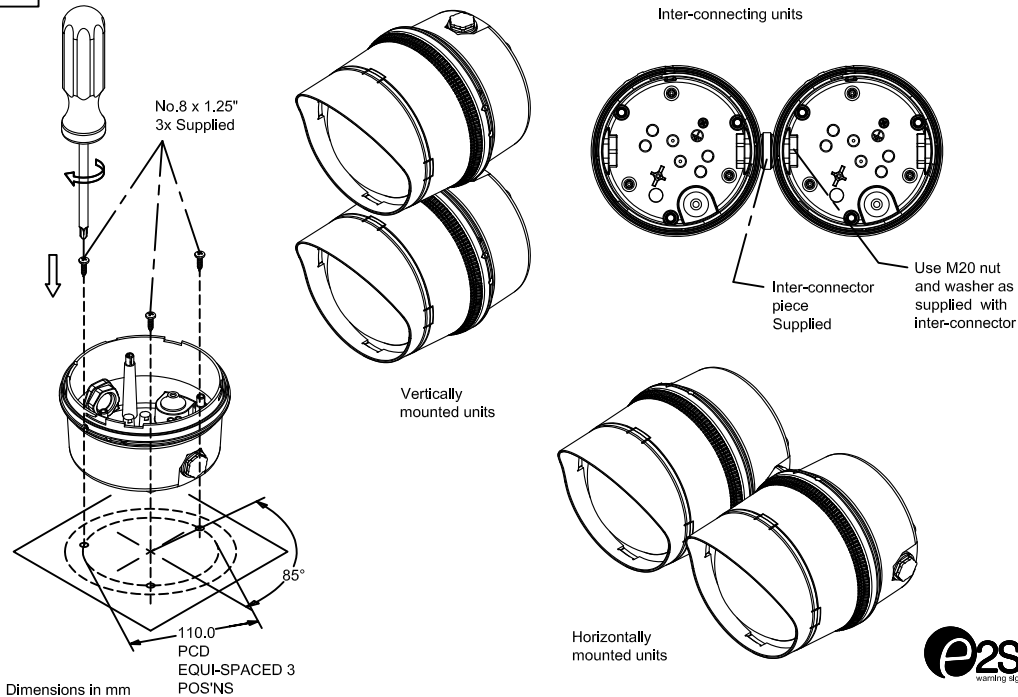

# D

